

RS (RZ)

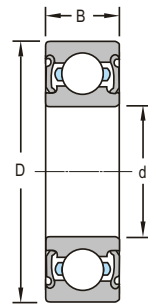

2RS (2RZ)

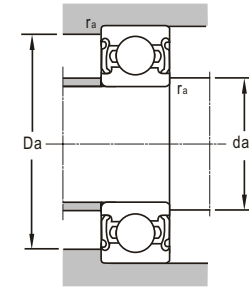
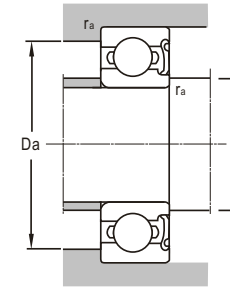

d 10~17mm

d	Boundary Dimensions			Basic Load Ratings		Limiting Speeds	
	D	B	r <sub>min</sub>	Dynamic C	Static C <sub>0</sub>	Grease	Oil
mm				kN		r/min	
10	30	9	0.6	5.11	2.39	17000	
	30	9	0.6	5.11	2.39	17000	
	30	9	0.6	5.1	2.39	19000	
	30	9	0.6	5.1	2.39	19000	
	35	11	0.6	8.06	3.4	17000	
	35	11	0.6	8.06	3.4	17000	
37	14	0.6	5.11	2.39	14000		
12	28	8	0.3	4.98	2.39	17000	
	28	8	0.3	4.98	2.39	17000	
	28	8	0.3	4.98	2.39	19000	
	28	8	0.3	4.98	2.39	19000	
	32	10	0.6	6.89	3.1	15000	
	32	10	0.6	6.89	3.1	15000	
	32	10	0.6	6.89	3.1	17000	
	32	10	0.6	6.89	3.1	17000	
	37	12	1	9.75	4.15	17000	
	37	12	1	9.75	4.15	17000	
	37	12	1	9.75	4.15	14000	
	37	12	1	9.75	4.15	14000	
	42	18	1	9.71	4.19	13000	
	42	18	1	9.71	4.19	13000	
15	32	9	0.3	5.48	2.8	14000	
	32	9	0.3	5.48	2.8	14000	
	35	11	0.6	7.8	3.75	13000	
	35	11	0.6	7.8	3.75	13000	
	35	11	0.6	7.8	3.75	15000	
	35	11	0.6	7.8	3.75	15000	
	35	14	0.6	7.64	3.72	13000	
	42	13	1	11.4	5.4	14000	
	42	13	1	11.4	5.4	14000	
	42	13	1	11.4	5.4	12000	
	42	13	1	11.4	5.4	12000	
	17	35	10	0.3	5.93	3.18	15500
35		10	0.3	5.93	3.18	15500	
35		10	0.3	5.93	3.18	13000	
35		10	0.3	5.93	3.18	13000	
40		12	0.6	9.56	4.75	14500	
40		12	0.6	9.56	4.75	14500	

Bearing Designations		Mounting Dimensions			Mass
Present	Original	d <sub>amin</sub>	D <sub>amax</sub>	r <sub>amax</sub>	
		mm			kg
6200-RS	160200	14	26	0.5	0.0296
6200-2RS	180200	14	26	0.5	0.0296
6200E-RZ	160200K	14	26	0.6	0.0295
6200E-2RZ	180200K	14	26	0.6	0.0295
6300 E-RZ		14	31	0.6	0.0508
6300 E-2RZ		14	31	0.6	0.0483
6400 EWBTN1-2RZ		14	33	0.6	0.0766
6001E-RS		14	26	0.3	0.021
6001E-2RS		14	26	0.3	0.02
6001 E-RZ	160101 EK	14	26	0.3	0.0217
6001 E-2RZ	180101 EK	14	26	0.3	0.0221
6201 E-RS	160201	16	28	0.6	0.0347
6201 E-2RS	180201	16	28	0.6	0.0356
6201 E-RZ	16020K	16	28	0.6	0.025
6201 E-2RZ	180201EK	16	28	0.6	0.034
6301E-RZ		17	32	1	0.0572
6301E-2RZ		17	32	1	0.0566
6301 E-RS		17	32	1	0.0573
6301 E-2RS		17	32	1	0.0566
62401X1S-RS		17	37	1	0.128
62401X1S-2RS		17	37	1	0.127
6002 E-RZ	160102EK	17	30	0.3	0.0292
6002 E-2RZ	180102EK	17	30	0.3	0.0292
6202E-RS	160202	19	31	0.6	0.0419
6202E-2RS	180202E	19	31	0.6	0.0393
6202E-RZ	160202K	19	31	0.6	0.0419
6202E-2RZ	180202EK	19	31	0.6	0.0392
6202 EX2-2RS/C3		20	37	1	0.0839
6302E-RZ		20	37	1	0.082
6302E-2RZ		20	37	1	0.0839
6302 E-RS	160302E	20	37	1	0.08
6302 E-2RS	180302E	20	37	1	0.08
6003 E-RZ	160103EK	19	33	0.3	0.0364
6003 E-2RZ	180103EK	19	33	0.3	0.0364
6003 E-RS		19	33	0.3	0.0668
6003 E-2RS		19	33	0.3	0.0382
6203 E-RZ/C9	60203EKU	21	36	0.6	0.0657
6203 E-2RZ/C9	80203EKU	21	36	0.6	0.0657



Deep Groove Ball Bearings  
with seal

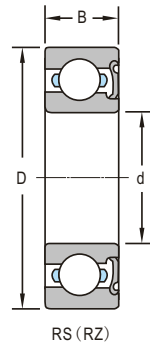

RS (RZ)

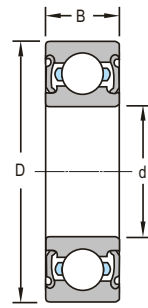

2RS (2RZ)

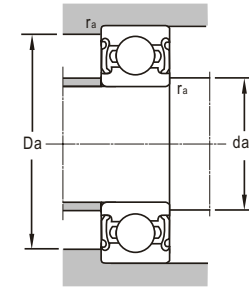
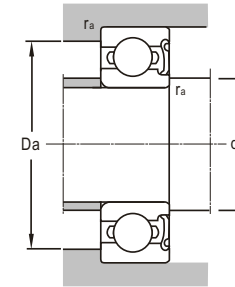

d 17~25mm

d	Boundary Dimensions			Basic Load Ratings		Limiting Speeds	
	D	B	r <sub>min</sub>	Dynamic C	Static C <sub>0</sub>	Grease	Oil
mm				kN		r/min	
17	40	12	0.6	9.56	4.75	12000	
	40	12	0.6	9.56	4.75	12000	
	40	12	0.6	9.5	4.75	14500	
	40	12	0.6	9.5	4.75	14500	
	47	14	1	13.5	6.5	11000	
	47	14	1	13.5	6.5	11000	
	47	14	1	13.5	6.5	12500	
20	42	12	0.6	7.22	4.46	12500	
	42	12	0.6	7.22	4.46	12500	
	42	12	0.6	9.15	4.9	11000	
	42	12	0.6	9.15	4.9	11000	
	47	14	1	12.7	6.5	10000	
	47	14	1	12.7	6.5	10000	
	47	14	1	12.7	6.5	11500	
	47	14	1	12.7	6.5	11500	
	47	18	1	12.7	6.5	11500	
	47	18	1	12.7	6.5	11500	
	52	15	1.1	15.9	7.8	11000	
	52	15	1.1	15.9	7.8	11000	
	52	15	1.1	15.9	7.8	9500	
22	50	14	1	13.7	7.5	10000	
	50	14	1	13.7	7.5	10000	
25	47	12	0.6	11	6.42	9500	
	47	12	0.6	11	6.42	9500	
	47	12	0.6	11	6.42	11000	
	47	12	0.6	11	6.42	11000	
	52	15	1	14.5	8.2	8500	
	52	15	1	14.5	8.2	8500	
	52	15	1	14.5	8.2	9500	
	52	15	1	14.5	8.2	9500	
	52	18	1	14.5	8.2	8500	
	52	18	1	14.5	8.2	8500	
	62	17	1.1	22.5	11.6	9000	
	62	17	1.1	22.5	11.6	9000	
	62	17	1.1	22.5	11.6	7500	
	62	17	1.1	22.5	11.6	7500	

Bearing Designations		Mounting Dimensions			Mass
Present	Original	d <sub>amin</sub>	D <sub>a max</sub>	r <sub>a max</sub>	
		mm			kg
6203 E-RS	160203E	21	36	0.6	0.0668
6203 E-2RS	180203E	21	36	0.6	0.0667
6203 E-RZ	160203EK	21	36	0.6	0.0667
6203 E-2RZ	180203EK	21	36	0.6	0.0665
6303E-RS		22	42	1	0.114
6303E-2RS		22	42	1	0.113
6303E-RZ		22	42	1	0.114
6303E-2RZ		22	42	1	0.113
6004E-RZ		24	38	0.6	0.0693
6004E-2RZ		24	38	0.6	0.0673
6004E-RS		24	38	0.6	0.0693
6004E-2RS		24	38	0.6	0.0693
6204 E-RS	160204E	25	42	1	0.104
6204 E-2RS	180204E	25	42	1	0.103
6204 E-RZ	160204K	25	42	1	0.104
6204 E-2RZ	180204EK	25	42	1	0.102
62204 E-RZ		25	42	1	0.133
62204 E-2RZ		25	42	1	0.133
6304E-RZ		26.5	45.5	1	0.147
6304E-2RZ		26.5	45.5	1	0.147
6304 E-RS		26.5	45.5	1	0.147
6304 E-2RS		26.5	45.5	1	0.147
62/22E-RS		27	45	1	0.119
62/22E-2RS		27	45	1	0.119
6005 E-RS		29	43	0.6	0.08
6005 E-2RS		29	43	0.6	0.08
6005 E-RZ		29	43	0.6	0.0756
6005 E-2RZ		29	43	0.6	0.0774
6205 E-RS	160205E	30	47	1	0.128
6205 E-2RS	180205E	30	47	1	0.126
6205 E-RZ	160205EK	30	47	1	0.124
6205 E-2RZ	180205EK	30	47	1	0.126
62205E-RS		30	47	1	0.158
62205E-2RS		30	47	1	0.157
6305E-RZ		31.5	55.5	1	0.225
6305E-2RZ		31.5	55.5	1	0.218
6305 E-RS		31.5	55.5	1	0.225
6305 E-2RS		31.5	55.5	1	0.225



Deep Groove Ball Bearings  
with seal

LYC®

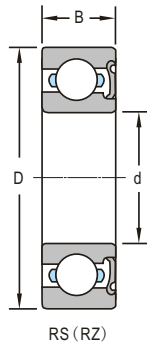

RS (RZ)

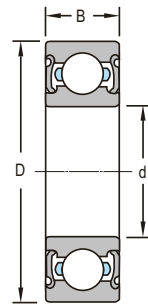

2RS (2RZ)

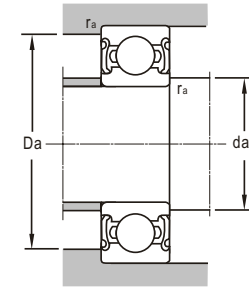
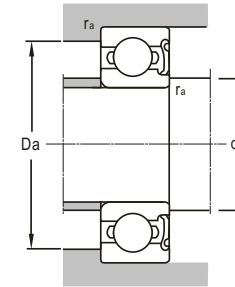

d 30~40mm

Boundary Dimensions				Basic Load Ratings		Limiting Speeds	
d	D	B	r <sub>min</sub>	Dynamic C	Static C <sub>0</sub>	Grease	Oil
mm				kN		r/min	
30	55	13	1	13.5	8.5	9500	
	55	13	1	13.5	8.5	9500	
	55	13	1	13.5	8.5	8000	
	55	13	1	13.5	8.5	8000	
	62	16	1	19.5	11.2	9000	
	62	16	1	19.5	11.2	9000	
	62	16	1	19.5	11.2	7500	
	62	16	1	19.5	11.2	7500	
	62	20	1	19.5	11.2	7500	
	62	20	1	19.5	11.2	7500	
	66	17	0.6	23.5	13.1		
	72	19	1.1	28.1	16	7500	
72	19	1.1	28.1	16	7500		
72	19	1.1	28.1	16	6300		
72	19	1.1	28.1	16	6300		
72	19	1.1	28.2	15.8	7100		
80	23	0.4	39.5	21.5	6500		
32	75	20	1.1	29.8	16.8	6300	
	75	20	1.1	29.8	16.8	6300	
35	62	14	1	16	10.3	7000	
	62	14	1	16	10.3	7000	
	72	17	1.1	25.5	15.3	7500	
	72	17	1.1	25.5	15.3	7500	
	72	17	1.1	25.5	15.3	6300	
	72	17	1.1	25.5	15.3	6300	
	80	21	1.5	36	19.5	7200	
	80	21	1.5	36	19.5	7200	
40	68	15	1	16.5	11.5	6300	
	68	15	1	16.5	11.5	6300	
	80	18	1.1	31.3	18.6	6600	
	80	18	1.1	31.3	18.6	6600	
	80	18	1.1	31.3	18.6	5600	
	80	18	1.1	31.3	18.6	5600	
	90	23	1.5	42	24	5000	
	90	23	1.5	42	24	5000	
	90	23	1.5	31.4	22.4	5000	

Bearing Designations		Mounting Dimensions			Mass
Present	Original	d <sub>amin</sub>	D <sub>amax</sub>	r <sub>amax</sub>	
		mm			kg
6006 E-RZ	160106EK	35	50	1	0.11
6006 E-2RZ	180106EK	35	50	1	0.11
6006 E-RS	160106E	35	50	1	0.114
6006 E-2RS	180106E	35	50	1	0.114
6206 E-RZ		35	57	1	0.21
6206 E-2RZ		35	57	1	0.2
6206 E-RS	160206E	35	57	1	0.02
6206 E-2RS	180206E	35	57	1	0.197
62206 E-RS		35	57	1	0.251
62206 E-2RS		35	57	1	0.254
6206EX3-2RSN		35	57	1	0.258
6306 E-RZ	160306EK	36.5	65.5	1	0.348
6306 E-2RZ	180306EK	36.5	65.5	1	0.348
6306 E-RS		36.5	65.5	1	0.349
6306 E-2RS		36.5	65.5	1	0.347
6306 ETN1-2RZ/P6		37	65	1	0.338
TM6307/30YA9-2RS1/P6CS28ZZ		38	72	0.4	0.524
63/32-RS		39	68	1	0.408
63/32-2RS	63/32E-2RS	39	68	1	0.408
6007 E-RS		40	57	1	0.151
6007 E-2RS		40	57	1	0.154
6207 E-RZ		41.5	65.5	1	0.287
6207 E-2RZ		41.5	65.5	1	0.28
6207 E-RS	160207E	41.5	65.5	1	0.27
6207 E-2RS	180207E	41.5	65.5	1	0.28
6307 E-RZ		43	72	1.5	0.466
6307 E-2RZ		43	72	1.5	0.42
6307 E-RS		43	72	1.5	0.42
6307 E-2RS		43	72	1.5	0.466
6008 E-RS		45	63	1	0.188
6008 E-2RS		45	63	1	0.188
6208 E-RZ		46.5	73.5	1	0.364
6208 E-2RZ		46.5	73.5	1	0.356
6208 E-RS	160208E	46.5	73.5	1	0.364
6208 E-2RS	180208E	46.5	73.5	1	0.355
6308 E-RZ	160308EK	48	82	1.5	0.609
6308 E-2RZ	180308EK	48	82	1.5	0.608
6308 E-2RS		48	82	1.5	0.608



Deep Groove Ball Bearings  
with seal

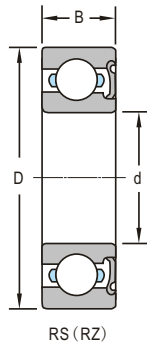

RS (RZ)

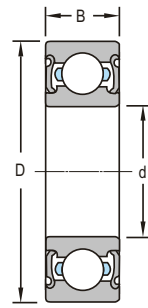

2RS (2RZ)

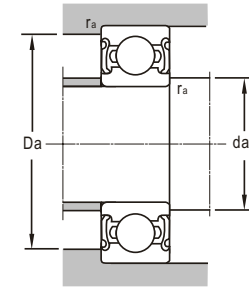
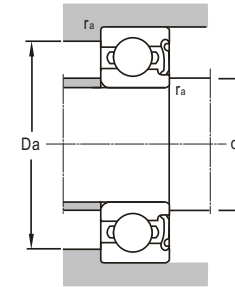

d 45~80mm

d	Boundary Dimensions			Basic Load Ratings		Limiting Speeds	
	D	B	r <sub>min</sub>	Dynamic C	Static C <sub>0</sub>	Grease	Oil
mm							
45	75	16	1	21	14.9	5600	
	75	16	1	21	14.9		
	85	19	1.1	32.2	21		
	85	19	1.1	32.2	21		
	100	25	1.5	53	30.5		
	100	25	1.5	53	30.5		
50	80	16	1	22	16.2	5000	
	80	16	1	22	16.2		
	110	27	2	61.8	37.9		
	110	27	2	61.8	37.9		
	110	27	2	61.8	37.9		
70	110	20	1.1	38.6	30.6	3600	
	110	20	1.1	38.6	30.6		
	125	24	1.5	62.2	44		
80	125	22	1.1	47.5	39.8	3500	
	170	39	2.1	120	83.9		
	170	39	2.1	120	83.9		

Bearing Designations		Mounting Dimensions			Mass
Present	Original	d <sub>amin</sub>	D <sub>a</sub> <sub>max</sub>	r <sub>a</sub> <sub>max</sub>	
mm					
kg					
6009 E-RZ		50	70	1	0.227
6009 E-2RZ		50	70	1	0.234
6209 E-RS	160209E	51.5	78.5	1	0.389
6209 E-2RS	180209E	51.5	78.5	1	0.417
6309 E-RZ	160309EK	53	92	1.5	0.845
6309 E-2RZ	180309EK	53	92	1.5	0.845
6309 E-RS		53	92	1.5	0.846
6309 E-2RS		53	92	1.5	0.846
6010 E-RS	160110E	55	75	1	0.252
6010 E-2RS	180110E	55	75	1	0.26
6310 E-RS	160310E	59	101	2	1.07
6310 E-2RS	180310E	59	101	2	1.07
6311 E-2RZ	180311E	59	101	2	1.07
6014 E-RS		76.5	103.5	1	0.563
6014 E-2RS		76.5	103.5	1	0.585
6214E-RS					1.1
6016-2RS		86	119	1	0.822
6316-RZ	160316K	91	159	2	3.61
6316-2RZ	180316K	91	159	2	3.61